

# Celebrate

---

A Guide for Senior Prep Families:  
Grades 4-7 2026

DAINFERN  
*College*



# Table of contents

|   |           |
|---|-----------|
| <b>Letter from the Principal of the Senior Prep</b> ..... | <b>2</b>  |
| <b>Introduction to Dainfern College</b> .....             | <b>3</b>  |
| Vision, Mission & Values .....                            | 3         |
| <b>Structure</b> .....                                    | <b>4</b>  |
| <b>Round Square</b> .....                                 | <b>5</b>  |
| <b>Community service</b> .....                            | <b>6</b>  |
| <b>Organisation</b> .....                                 | <b>7</b>  |
| School houses.....  | 7         |
| <b>General information</b> .....                          | <b>8</b>  |
| School calendar .....                                     | 8         |
| School attendance .....                                   | 8         |
| School day .....  | 8         |
| First day of term .....                                   | 9         |
| Student mentors .....                                     | 9         |
| New Parents' Welcoming Committee .....                    | 9         |
| Transport service .....                                   | 9         |
| Traffic control.....                                      | 9         |
| Medical emergencies .....                                 | 10        |
| Security .....  | 11        |
| <b>Academics</b> .....                                    | <b>12</b> |
| Academic offer .....                                      | 12        |
| Language choice.....                                      | 13        |
| Daily prep .....  | 13        |
| Academic support .....                                    | 13        |
| Meetings & reports .....                                  | 13        |
| Academic requirements .....                               | 14        |
| Bring Your Own Device .....                               | 15        |
| <b>Communication</b> .....                                | <b>16</b> |
| <b>Discipline</b> .....                                   | <b>16</b> |
| <b>Extramurals</b> .....                                  | <b>17</b> |
| <b>Culture, Clubs &amp; Service</b> .....                 | <b>17</b> |
| <b>Sport</b> .....  | <b>18</b> |
| <b>School uniforms</b> .....                              | <b>19</b> |
| Appearance of students.....                               | 19        |
| Wearing school uniform .....                              | 20        |
| Uniform requirements.....                                 | 21        |
| <b>General information</b> .....                          | <b>26</b> |
| <b>School map</b> .....                                   | <b>27</b> |
| <b>Term calendar</b> .....                                | <b>28</b> |

# From the Senior Prep Principal



It is a tremendous privilege to be entrusted with your children and to join you in their educational journey. To all our new families, we warmly welcome you and trust that your time with us will be a long and happy one.

In the Senior Preparatory, we are dedicated to offering a relevant and dynamic experience that is, most importantly, engaging for your children. We look at the child as a whole - recognising that each student is unique and talented. We offer a wide variety of activities so that every child can identify and optimally develop their strengths.

## Our Focus: Growth, Curiosity and Confidence

We believe that providing innovative learning experiences helps foster a 'growth mindset' in our students.

- A key focus for us is developing a culture of thinking and a natural curiosity for learning.
- We encourage students to engage in critical self-reflection and take responsibility for their own learning.
- Our goal is to nurture confident young students who are able to communicate and ultimately create effective change in the world around them.
- We know that future success requires a blend of skills along with passion, discipline, resilience and determination.

To support this, we have reviewed traditional assessment. We have moved away from high-stakes testing because we understand the negative impact it can have on a young student's self-confidence and belief in their own capabilities. Our aim is to create a stress-free environment for teaching and learning where students can focus on the mastering of skills and concepts.

## Partnership and Communication

We view this educational journey as a partnership, meaning our collective involvement and shared responsibilities serve in the best interests of each student. We celebrate our diversity, embrace each student's uniqueness, and endeavour to create a happy and caring environment where every student can celebrate their talents and contribute to the success of our school.

Please take the time to download the school smartphone app as this is a vital communication tool between the College and all parents/guardians.

Best wishes for a happy and successful year for all our families!

Should you need any further clarity on the information in this document, please contact your child's class teacher or mentor via email.

**Ray van Gass**

Principal: Dainfern College Senior Preparatory

# Introduction to Dainfern College

Dainfern College is a visionary, co-educational school founded on a Christian ethos and traditional core values, catering for students from Grade 0 to Grade 12. We are student-centred and holistic, and we strive for quality in all that we do. Our outstanding, committed teachers ensure that we have a strong and relevant academic focus. We have built a reputation for providing an innovative education, as well as individual opportunities and excellence in the sporting, cultural and outreach spheres.

## Vision

“To become recognised as one of the leading educational institutions in the country.”

## Mission

Dainfern College develops **skills for life** required to unlock unique personal potential and to nurture **creative thinkers** with the confidence to become **leaders** – through the provision of an innovative, relevant and quality education.

## Core values: ‘FISHAR’

- **Fortitude:** Showing courage and resilience in the face of challenge.
- **Integrity:** Being honest and showing strong moral principles.
- **Self-discipline:** Correcting and regulating one’s own behaviour.
- **Humanity:** Showing compassion and consideration for others.
- **Accountability:** Taking responsibility for one’s choices and actions.
- **Respect:** Showing consideration for the feelings and rights of others.

# Structure

Dainfern College operates as a non-profit company.

The **Board of Governors** is responsible for the governance of the school. It appoints the Principals and has a strategic and fiduciary responsibility.

The **Finance Committee** is a sub-committee of the Board of Governors: it oversees the finances of the College and sets the fees on an annual basis.

The **College Executive**, comprising the Executive Head of College (who also serves as the Principal of the High School), the Principals of the Senior and Junior Preparatory Schools, and the Business Director, are responsible for the educational leadership and operational management of the College. The CEC is chaired by the Executive Head.

The **Dainfern College Parents' Association** plays an active role at the College. The objectives of the Association are threefold: liaison, social interaction and fundraising. All parents/guardians are welcome to become a part of this body.

For further information contact the PA at [pa@dainferncollege.co.za](mailto:pa@dainferncollege.co.za).

The **Dainfern College Foundation** is focused on being a positive driver of change both within Dainfern College as well as the broader education arena, by multiplying the impact of our education facility on the world around us.

The Foundation aims to raise funds for Dainfern College to ensure that the College remains at the forefront of independent education in South Africa. We have developed a fundraising strategy, known as the **Celebration Campaign**, to support three strategic areas that need financial support:

- **Our Community:** for positive impact on the lives of vulnerable and less fortunate children via feeding, education and other outreach initiatives.
- **Our Campus:** to enhance our facilities to be a benchmark, world-class reference over the long term.
- **Our Continuity:** to create a sustainable capital platform to fund ongoing projects from investment returns.

The Foundation is a separate registered trust with Public Benefit Organisation status and is managed by a Board of Trustees.

For further information or to contribute to one of the strategic areas, please contact Ms Lindokuhle Sithole, our Foundation Manager and Head of Advancement, at [lsithole@dainferncollege.co.za](mailto:lsithole@dainferncollege.co.za).

# Round Square



Round Square is a world-wide association of more than 260 schools on six continents that share unique and ambitious goals. Students attending Round Square schools make strong commitments beyond academic excellence towards personal development and responsibility.

Dainfern College has been a Global member of Round Square since 2012, giving our students the opportunity to participate in conferences, community service, work projects, exchange programmes and adventuring experiences, which can, and often do, take students half way around the world. We have successfully hosted both a Regional Conference and an International Conference for the 12–14-year-old age group, bringing together hundreds of students from all over the world.

## **IDEALS**

As a proud Round Square school, we take a holistic approach to education and inspire our students through experiential learning using the Round Square IDEALS of International Understanding, Democracy, Environmentalism, Adventure, Leadership and Service. One of our deliberate intentions is to embrace Round Square in its totality and bring the IDEALS of Round Square to the core of all that we do. Not only does this benchmark us against the top schools in the world but it continues to expose our students and staff to international best practice.

## **DISCOVERIES**

The Round Square Discovery Framework, linked through all three phases of our school from Grade 0 to Grade 12, looks to create more ways of synthesising academic, skills-based, experiential, social-emotional learning. This powerful combination is perfectly aligned with our own FISHAR value system (see page 3) and allows vital character-based education to take place. Our students are encouraged through Round Square to be the best individuals they can be by developing the essential discoveries of Tenacity, Courage, Self-awareness, Compassion, Inventiveness, Sense of Responsibility, Communication, Problem Solving, Teamwork Skills, Commitment to Sustainability, Inquisitiveness and Appreciation of Diversity.

For further information, please contact our Senior Prep School Round Square staff representative, Mrs Eva Odendaal ([eodendaal@dainferncollege.co.za](mailto:eodendaal@dainferncollege.co.za)).

## Community service

Community service is strongly encouraged throughout Dainfern College. We work on smaller projects throughout the year including collection drives across the College that include Easter, Winter Warmth and Christmas. We participate in Mandela Day activities every year and support activities such as the CANSA Shavathon, CF Genes Day and so on.

In addition, we also concentrate our efforts on the following partnerships:

**ReShomile:** With its very limited resources and infrastructure, this school educates 1 700 students. The objective of our twinning initiative with ReShomile is one of academic upliftment and mutual benefit. An immediate need is the sponsorship of food packs and clothing to child-headed families. The Dainfern College Foundation runs a sponsorship programme for members of our community to participate in for as little as R130,00 per month. Once a month, the Foundation's nutrition support programme delivers food parcels to the vulnerable children at the school. For many, these parcels are all that stand between them and starvation.

**Crèches:** We have a partnership with two crèches in Cosmo City. This partnership was established in 2005 when the crèches were run from the informal settlement known as Zevenfontein. Both schools have grown from 20 children to over 100 children. Their facilities are very limited, and they have no space in which to run around. We also partner with a crèche in Riverside. We support these crèches with equipment and run crèche days for each one once a term.

**LEAP 4 School:** The LEAP learning model is designed to support children from South Africa's township communities to become South Africa's leaders of the future. Each LEAP school is partnered by a neighbouring independent school. Dainfern College partners with the LEAP 4 School in the Diepsloot area, constantly working together to create opportunities for sharing and interacting across many areas of school life as well as supporting vulnerable students through our nutrition support programme.

## Organisation

Dainfern College caters for children from Grade 0 to Grade 12, and also has close ties with our on-campus nursery school, Country Readiness. There are thus four phases of education on our campus:

- Country Readiness:           Grade 0000 – Grade 00
- Junior Preparatory:        Grade 0 – Grade 3
- Senior Preparatory:        Grade 4 – Grade 7
- High School:                Grade 8 – Grade 12

All students in the Preparatory School are divided into classes of mixed ability, with a maximum of 26 students per class, with the following exceptions:

- In the event of a staff member's child joining the school.
- To replace a future leaver.
- Where a new family joins with three or more children and two of the children can be accommodated.
- For consolidation/acceleration of students.

**Senior Prep MANCO:** The Senior Preparatory Management Committee comprises the Principal of the Preparatory School, three Deputy Principals and a Divisional Manager:

### **Deputy Principal: Academics**

Mrs Louise Browne

[lbrowne@dainferncollege.co.za](mailto:lbrowne@dainferncollege.co.za)

### **Deputy Principal: Curriculum Development & Student Wellbeing**

Mrs Sandi Tyson

[styson@dainferncollege.co.za](mailto:styson@dainferncollege.co.za)

### **Deputy Principal: Operations**

Mr Sandile Mkhize

[smkhize@dainferncollege.co.za](mailto:smkhize@dainferncollege.co.za)

### **Divisional Manager: Organisation & Logistics**

Mrs Sandy St Clair

[sstclair@dainferncollege.co.za](mailto:sstclair@dainferncollege.co.za)

There are also Heads of Subjects and Heads of Grade. These details and email addresses can be found on the school app.

## School Houses

The three Houses at Dainfern College are Griffin (Yellow), Kraken (Blue) and Phoenix (Red). All students are allocated to Houses when they join the College and siblings are always placed in the same House. A number of InterHouse competitions take place throughout the year and all students are encouraged to participate.

# General information

## School calendar

Dainfern College operates a **three-term** academic year. The Year calendar, with the dates of the school terms and holidays can be found on our school smartphone app and on the school website. The live Term calendar is also on the school app – we recommend you sync the live Term calendar with your own personal calendar so as to ensure your calendar is automatically updated with any additions or changes to school events.

**NB. Parents/guardians are requested to arrange their holidays to coincide with official school holidays. Requests for students to miss school during term time will NOT be considered, except under exceptional circumstances. An email then needs to be sent to the Principal and class teacher for consideration.**

## School attendance

It is legally compulsory for children to attend school, and absence from school will not be condoned, unless the student is ill, or there are exceptional circumstances requiring the absence, or if the absence has been occasioned by infectious/ contagious diseases. **Any contagious diseases should immediately be reported to the school.**

**Lice:** If a student has lice, he/she will not be allowed at school until such time as a clearance certificate from a clinic/doctor has been obtained.

A note from the parent is required to explain all absences. A doctor's certificate is required if a student is away from school for more than three days. A doctor's certificate is also required if a student misses a test or examination.

## School day

### Monday-Thursday

- **07h25:** The school day commences with registration, devotions and notices
- **13h30:** End of the formal academic timetable
- **13h30:** Commencement of cultural extramural timetable and the Academic Focus programme for all students for English, Afrikaans, isiZulu and Mathematics (students not involved in extramurals or academic focus on a particular day go home at the end of the academic day)
- **14h15:** Sports extramural timetable commences

### Friday

- **07h25:** The school day commences with registration, devotions and notices
- **13h00:** End of formal academic timetable. School closes for students not involved in the sports and cultural extracurricular programmes

## First day of term

Returning Senior Preparatory students need to report to their class teachers/mentors on **Wednesday, 14 January 2026**. Students new to the College are to report to the Main Reception where they will be welcomed by the Senior Prep Counsellor.

## Student mentors for Grade 6 & 7 students

At Dainfern College, we have always prioritised the importance of each student's social and emotional well-being, which forms part of our pastoral care programme. Relationships among students and with the staff are key to establishing trust within a safe and caring environment.

To this end, the Senior Prep allocates two members of staff per class in Grades 6 and 7 to provide support for each student. As mentors, these staff members will be the direct link between parents/guardians and the school for any personal school-related matters associated with one of their students.

## New Parents' Welcoming Committee

There is a support group for new parents/guardians, coordinated by the Parents' Association – please contact Ms Lindokuhle Sithole in the College Advancement department or email her at [lsithole@dainferncollege.co.za](mailto:lsithole@dainferncollege.co.za) for further information.

## Transport service

Dainfern College has engaged the services of a company called KVE-Driven which offers transport services for your children. KVE-Driven has an outstanding reputation and has been in the business of transporting children since 2006. The following areas are serviced by dedicated KVE-Driven transport: Dainfern and surrounding estates, Broadacres, Chartwell, Cedar Lakes, Craigavon, Fourways and Fourways Gardens, Helderfontein, Beverley, Lonehill, Paulshof, Bryanston, Pineslopes, Douglasdale, Witkoppen, Glenferness, Kyalami and Sandton.

For more information, please contact the KVE-Driven office on 082 594 7528 or email them at [info@kve-driven.co.za](mailto:info@kve-driven.co.za).

## Traffic control

**Speed limit:** The speed limit on the College campus is **15km/h**. This limit needs to be adhered to at all times, please.

**One-way system:** Between 06h30 and 08h00, and 12h00 and 14h30, a **one-way** system of traffic flow operates, the entrance being at the main gate and the exit at the top gate behind the JP block. At all other times, the top gate is locked, and all traffic enters and exits through the main gate.

**Drop & drive:** Parents/guardians are requested to drop Senior Prep students at the Rain Shelter situated in the pool parking area. Parents/guardians may not leave their vehicle unless they have an appointment, in which case they should park in the designated parking (see below).

**Collection zones:** In normal circumstances, students are collected in the pool area parking or from their sport's extramural venue. Grade 4 and 5 students are collected at the small waiting area shelter and Grade 6 and 7 students from the rain shelter.

**Collection during lightning alert:** When the school is under lightning alert, students are not allowed in the College waiting areas until the lightning alert period has elapsed and the all-clear siren has activated. Unless otherwise indicated below, students must be collected from the main grandstand.

- MPH – students remain in the MPH
- Students engaging in sport on the bottom field, bottom and middle courts meet at the Pavilion (bottom field).
- Students at the Cricket Academy / nets / Main Oval or the pool move to the main grandstand.

**Parking:** During peak hours, no parking is allowed alongside the pool area, outside the High School classrooms close to the main tuckshop, by the High School quad and alongside the Grade 0 playground. These are used as 'Drop & drive' areas. Should a parent need to park, the designated parking areas are to the left of the main gate entrance, in front of the swimming pool. A limited number of bays are also available in **off-peak hours** at Main Reception and outside the High School quad. **Please do not park or 'stop and drop off' in the staff parking (shade ports).**

## Medical emergencies

**Nurse & ambulance service:** We have a school nurse on campus each day until 16h00. We have also engaged with an emergency services provider for assistance in getting injured parties to hospital and getting access to treatment at the hospital without any unnecessary delays.

**Emergency medicine:** Should any student have a serious allergy or condition (such as asthma) and require emergency medicine to be kept at the school, this can be left with the class teacher or school nurse. Teachers **must** be informed as to where emergency medicines can be sourced, and this fact needs to be kept on Ed-admin via the parent portal. **A form needs to be completed giving specific teachers as well as the school nurse permission to administer this medication.** Allergies need to be highlighted on application forms to ensure they are entered on the student's file.

**Over-the-counter medication:** The school nurse has some basic over-the-counter medication available for the treatment of minor ailments. These may only be dispensed

with permission from parents/guardians, and parents/guardians will be asked to complete a form that will be kept on record.

## Security

**Security system:** A security system, involving active guarding and strategic camera coverage of all access/egress control, is operational at all times.

**Security guards:** Please treat the security guards with courtesy should they need to stop you or inconvenience you in any way during the course of their duties. They have been empowered to search cars randomly if a need arises. Please remember: **they are there for the safety and protection of you and your child.**

**Car access stickers:** Two access stickers are allocated to each family upon enrolment. These are updated every year. Cars not displaying access stickers will not be allowed into the College without scanning of the vehicle licence and driver's licence. Additional stickers can be obtained from Reception, and must be signed for.

**Students leaving early:** Should a student need to leave school early for a particular reason, approval needs to be gained from the relevant class teacher/mentor. A written note or email is required. All students leaving early must be fetched by an adult who needs to report to the Main Reception area. An 'Exit Slip' needs to be completed and this must then be given to the guards at the gate.

**Use of College facilities after hours:** In order to prevent unauthorised persons from using and potentially abusing College facilities, all Dainfern College students and parents/guardians wishing to use our facilities over weekends, public holidays and school holidays are asked to produce some form of identification at the entrance gate to prove their association with Dainfern College.

# Academics

In response to international trends in education, the Senior Prep curriculum is designed to inculcate a 'growth mindset' that will serve in the best interests of our students. Innovation, Leadership and Internationalism are the core drivers of our strategy. Subject proficiency in English, Mathematics and Additional Languages form the core of our curriculum.

The Inquiry-based Learning framework focuses on moving students beyond general curiosity into the realms of critical thinking, higher order problem-solving skills, research skills, effective communication, resilience and creativity. The integration of technology is seen as a fundamental part of the students' learning experience through relevant educational applications that facilitate 21<sup>st</sup> Century skills and real-world experiences.

The academic focus programme is made available to all students to assist individuals in their learning at differentiated levels. Focus lessons include English, Afrikaans, isiZulu and Mathematics.

We constantly re-evaluate and refine our academic approach to ensure that our College remains at the cutting edge of educational trends, providing all our students with the relevant skills and knowledge to equip them for the future.

The academic year in the Senior Preparatory is divided into three terms. Class teaching predominates in Grades 4 and 5, while Grade 6 and 7 students attend lessons in the specialist teachers' designated classrooms. All students have specialist teachers for Afrikaans and isiZulu, Technology, the Creative Arts, Character Education and Physical Education. Class teachers (Grade 4 & 5) and Class mentors (Grades 6 & 7) are responsible for the overall pastoral care of the students in their classes.

## Academic offer

- Languages (English and Afrikaans/isiZulu)
- Mathematics & Reasoning
- Character Education (P4C, Thrive Together & Life Orientation)
- Creative Arts (Drama, Music & Visual Arts)
- Economic & Management Sciences (EMS) - Grade 7
- Natural Sciences (Science & Biology) - Grades 6 & 7
- Social Sciences (History & Geography) - Grades 6 & 7
- Technology & Digital Ethics
- Design & Explore
- Mentorship
- Physical Education

## Language choice

In the Intermediate Phase (Grades 4-6), students study either Afrikaans or isiZulu as their First Additional Language. The choice of language is made at the end of Grade 3 so that students start their chosen language from the beginning of Grade 4 to enable more academic teaching time in that language during their Senior Prep years. Please direct any queries to your class teacher or Mrs Louise Browne, Deputy Principal: Academics.

## Daily prep

We have deviated from traditional homework as a means to consolidate learning as research has shown the benefits to be minimal at this young developmental age. In Grades 4-6 daily prep activities include essential language and mathematical skills, as well as reading and preparation for upcoming lessons. Grade 7 is different as these students are working in a mark-based system which forms the basis of their assessments. Grade 7 students receive daily homework activities and are also required to prepare for their various assessments in preparation for Grade 8.

## Extra academic focus lessons

Academic focus lessons for English, Afrikaans, isiZulu and Mathematics take place from Monday to Thursday straight after the academic day for any Senior Prep students (Grades 4-7) requiring additional assistance. Teachers are available to assist any student requiring support in any subject.

## Individual academic support

Dainfern College prides itself on providing individual academic, remedial and emotional support to our students. Academic support is offered to students in Grades 4 to 7 by external therapists who work on the College premises. Remedial academic support is available, the cost of which is for the parents/guardians' account and paid directly to the therapist concerned. For further information about student support, please contact Mrs Lauren Nel, our Student Support Specialist, at [lnel@dainferncollege.co.za](mailto:lnel@dainferncollege.co.za).

## Meetings & reports

**Student-led conferences:** The concept of a 'student-led conference' complements the traditional parent/teacher interviews. A student-led conference is a scheduled meeting between the student, the parents/guardians and the assigned teacher in which the students are given an opportunity to share their academic progress and reflect on their strengths and challenges. The discussion, led by the student, focuses on the mastery of concepts/skills in English, Mathematics and the first additional language, as well as character skills and socio-emotional and leadership development. The discussion is coordinated through an age appropriate 'script' and a 'portfolio of work' to celebrate each student's progress and achievements.

The benefits of a student-led conference are as follows:

- It allows students to take accountability for their learning.
- The 'experience' is an honest reflection of how the student is feeling about his/her learning as well as possible remedies where more effort is required.
- It is an opportunity to reflect on their progress and personalised challenges.
- Students develop organisational and oral communication skills.
- Students learn the process of self-evaluation.
- It enables students to set personalised goals for their immediate future.
- For parents/guardians, it is an opportunity to gain an understanding of their child's progress through open and honest dialogue, whilst enabling insight into classroom activities and curriculum offering.
- It is an opportunity for parents/guardians to encourage their child to accept personal responsibility for their academic performance.
- Evidence-based portfolio of work to support the feedback progress

Student-led conferences are scheduled in Term 1 and Term 2.

**Teacher-Parent Meetings:** We have an open-door policy, and parents/guardians are encouraged to contact teachers at any time. Teachers will also contact parents/guardians if they deem it necessary to discuss any concerns. Over and above this, more formalised parent-teacher sessions are scheduled throughout the year.

**Reports:** Our academic year is divided into two semesters: Semester 1 is January to June, and Semester 2 is July to December. At the end of Term 1 an interim report will be issued that offers a broad overview of how students have settled and progressed during the term. Detailed reports are issued at the end of each semester.

## Academic requirements

**Stationery:** Stationery lists for the following year are sent to Grade 4-7 students in Term 3. For your convenience, the school has a preferred supplier that makes up stationery packs for you according to the requirements of each grade. The price is competitive, and the packs are delivered to the students at school. Alternatively, you may purchase the required stationery yourself. Stationery lists are available on the website (<https://www.dainferncollege.co.za/stationery-textbooks/>) and on the College app under Useful Information/Senior Prep/Academics

**Textbooks:** Textbooks, workbooks and online subscriptions are arranged by the school. An annual levy is charged to parents/guardians at the beginning of the year which covers the costs of the academic requirements of each year.

## Bring Your Own Device: Grades 4-7

All Senior Preparatory students are required to have a device at school. The Senior Preparatory has made the decision to only use Chromebooks. This recommendation is based on the longevity of these devices as well as the management of digital safety. The Chromebook will be used throughout your child's Senior Preparatory journey and will then be used in high school. It is important to ensure when purchasing a Chromebook that it is able to run the latest operating system available.

### Chromebook specifications

Below are the suggested minimum specs for the Chromebook:

- Intel® N100 processor Quad-core
- Intel® UHD Graphics shared memory
- 11.6" HD (1366 x 768) 16:9 60 Hz Touchscreen
- 4 GB, LPDDR5
- 32 GB eMMC Flash Memory

We have partnered with a company that offers convenient Chromebook delivery to the school. This includes the Google Edu Licence that allows the school to manage the device. There is no obligation to use their services, but if you wish to, please visit <http://dainfern.chromestore.co.za/> to place an order.

You may of course choose to buy the device through a different outlet. However, you will still be required to buy the Google Edu Licence at a once-off cost from the company we partner with as this licence is a requirement for device usage.

The Chromebooks are to be maintained by the student, and we have placed support and training structures in place to assist both students and staff.

**Lockers:** Lockers are available for Grade 6 and 7 students. Each student is allocated two lockers: one for their general school bags and one for their device. Grade 4 and 5 students will be able to keep their devices in secure cabinets in their classrooms.

Should you have any queries about the specifications of the Chromebook or the device expectation in the Senior Preparatory, please contact our Director of Technology, Mr Anthony Egbers, on [aegbers@dainferncollege.co.za](mailto:aegbers@dainferncollege.co.za).

## Communication

**App:** The school smartphone app is an invaluable communication tool for parents/guardians. It contains a wealth of information including schedules, newsletters and events as well as staff details and calendars, and ensures you receive important notices from the school. It is available for free download from the iStore and Google Play Store (code is **dc97**). Contact our Communication & Compliance Manager, Mrs Joanna Pettitt at [jpettitt@dainferncollege.co.za](mailto:jpettitt@dainferncollege.co.za) should you have any queries about the app.

**Newsletters** for the Prep school and for the High School are available on our website and app. Newsletters are updated every second Friday.

**Parent portal:** The parent portal contains specific parent and student details including contact details, health records, school reports and account information. Each parent is given a username and password to access the parent portal. Please contact Mr Hein Hildebrand ([hhil@dainferncollege.co.za](mailto:hhil@dainferncollege.co.za)) for assistance with accessing the portal.

**Parent Information Evenings** are held at the start of the year.

### Cell phone policy

The Senior Preparatory is a smart phone free school and **Senior Preparatory students are not permitted to have cell phones on the Dainfern College campus.**

Should a parent need to contact their child during the school day, they should contact Main Reception (011 469 0639), and our staff will then ensure that a message is conveyed to the student.

### Communication from parents/guardians

Should parents/guardians have a concern about their child/ren, they are welcome to set up an appointment with the relevant staff member. This can be done by emailing the teacher. Email addresses are available on our app and website. So that any problems can be sorted out as close to the source as possible, we request that you use the following route:

Class/subject teacher → Head of Grade → Deputy Principal → Principal

## Discipline

Dainfern College has entrenched a restorative approach to behavioural concerns, which is fundamental to our philosophy of positive education. 'Choice, Consequence and Reflection' define our approach, and our Code of Conduct underpins the ethos and core values of the school. The Code is available on our website, with other applicable policies.

## Extramurals

All students are required to participate in a minimum of one activity per season, selected from the extramural programme.

### CULTURE & CLUBS

Cultural activities are a vital part of the holistic offer at the College, igniting both imagination and creativity. Our exciting Senior Preparatory cultural offer encompasses a wide variety of music ensembles as well as Art and Chess. Making music together as part of an ensemble enriches and enhances musical growth and gives students a sense of achievement for being part of a musical creation. Students unable to attend a practice or performance need to excuse themselves in advance.

There are also several clubs available to students.

The following activities are offered in the Senior Preparatory:

- Band
- Chess
- Choir
- Drama
- Guitar & String Ensembles
- Keyboard Ensemble
- Marimba Ensembles
- Music Theory
- Public Speaking
- Ukelele
- Art Club
- Book Club
- Robotics Club (*paid extramural*)
- Science Club

**Ballet lessons** after school are also available for parents/guardians' account – contact Mrs Colleen Theys on 083 270 4074 for further information.

### Individual music

Dainfern College has a thriving Music Centre, and private teachers are available at the school to teach a wide variety of disciplines (piano, guitar, cello, violin, flute, drums, voice etc). The cost of these lessons is for the parents/guardians' account. Further information is available on the Dainfern College app, under 'Music Centre'. Enquiries and applications should be sent to Ms Boitumelo Sikonkwane, our Music department administrator, at [bsikonkwane@dainferncollege.co.za](mailto:bsikonkwane@dainferncollege.co.za).

### SERVICE

**Outreach:** Working with our community schools and various service drives.

## SPORT

As physical literacy is fundamental to the development of a child, sport at Dainfern College is viewed as an essential component of our holistic offer. In addition to promoting a healthy lifestyle, life skills and values are learnt and a love for activity and sport is developed in each individual.

### Physical Education lessons

Physical Education lessons take place during the school day and focus on improving mobility and coordination as well as the acquisition of specific sports skills and techniques. Should your child be unable to participate in these lessons for any reason, please ensure that you contact their PE teacher either by email or by sending a note to school. Staff contact details can be found on the app.

Our students are exposed to a variety of sporting codes in the Senior Preparatory and students are encouraged to participate in at least one school sport per season. Students unable to attend a practice or fixture need to excuse themselves in advance.

### Sports extramurals

- Athletics
- Cricket (boys and girls)
- Cross Country
- Equestrian\*
- Golf (*paid extramural*)
- Hockey – Indoor & outdoor
- Netball
- Rugby
- Soccer
- Swimming
- Tennis

*\*Equestrian is recognised as a school sport and our riders represent Dainfern College in their events. As the College does not have the required facilities for Equestrian these activities therefore take place off campus and are managed solely by parents/guardians.*

**Dragons' Hockey and private coaching for Cricket, Hockey and Tennis** are all available on campus for parents/guardians' account.

**Practices:** Should a Senior Prep match/fixture/practice be cancelled due to inclement weather, children are allowed to go home unless alternative arrangements have been made. Galas/meetings and matches are only cancelled at 12h00 on the day of the fixture. Students will be notified before second break if a fixture is cancelled. This will be communicated to parents/guardians via the app.

# School uniforms

## Appearance of students

All students are expected to take pride in their appearance and to dress appropriately, ensuring that their appearance reflects positively on themselves and on the image of the College.

The Appearance & Uniform Policy is available on the website and on the app and will be consistently applied to all students. To be as inclusive as possible, taking into account students' religious requirements and cultural expectations, the College reserves the right to make allowances for appropriate conditions or cultural or religious traditions when such application is made to the College.

Casual clothes may only be worn to school on specifically arranged Civvies Days.

No tournament, camp, tour attire / uniform or part thereof may be worn at any school function, practices or matches.

**Hair:** Hair must be worn in a clean, neat and tidy manner. Extremes in hairstyling are not permitted; no dyed / highlighted / spiky / beaded hairstyles are allowed, and hair must be one colour. Fringes may not touch the eyebrows.

- **Boys:** Hair must be neatly trimmed and not touch collars or ears. Sideburn length to mid-ear only.
- **Girls:** Hair must be neatly tied up once the length reaches the collar. Long fringes and loose pieces of hair must be clipped back neatly. Navy blue or white hair bands or school tartan scrunchies are required. Only school tartan or navy blue alice bands may be worn.

### **Shoes:**

- **Boys:** Polished, clean, black school shoes are to be worn.
- **Girls:** Polished, clean, black school shoes are to be worn.

**Jewellery:** No jewellery is allowed, except for Medic Alert discs, plain watches and religious emblems. Girls may wear only gold or silver studs or sleepers in pierced ears (one per earlobe).

**Make-up & nail varnish:** No make-up is allowed to be worn at school. Clear nail varnish (only) is permissible.

**Gum:** Chewing gum is not permitted at school.

## Wearing school uniform

Students wear full school uniform every day unless they have PE that day, in which case they may wear PE kit to school.

The school blazer is part of the Grade 7 uniform and must be worn at assemblies and on formal occasions. Occasionally permission is given not to wear it because of particularly hot weather.

All uniform items **must** be clearly labelled.

Uniforms are available from:

- **McCullagh & Bothwell** - the school uniform stockist can be found on the upper level of Fourways Crossing (Tel: 011 705 1070).
- **The College Uniform Shop**: Open from Monday to Friday from 07h15 to 08h00, and on Thursday from 13h45 to 14h15. They have excellent stock of second-hand uniforms at good prices. The Uniform Shop can be found opposite the main tuckshop of the College. Senior Prep and High School lost property is also kept here. Contact [collegeshop@dainferncollege.co.za](mailto:collegeshop@dainferncollege.co.za) with any enquiries.

**The Public Domain:** Please note that if students wear their uniforms in public places, they are required to be in full school uniform, including shoes and socks, and to be neatly presented. Otherwise, they need to have changed into casual clothes.

## Uniform requirements for Grades 4 to 6

|        |   |
|--------|---|
| SUMMER | <b>GRADE 4-6 BOYS</b>   |
|        | White cotton tuck-in shirt with badge Navy tailored shorts<br>Dainfern College long navy socks & Black school shoes<br>Dainfern College navy jersey with badge<br>Dainfern College peak cap   |
| SUMMER | <b>GRADE 4-6 GIRLS</b>  |
|        | White cotton blouse with badge with side slits (not tucked in)<br>Dainfern College tartan skirt OR culottes<br>Short white socks and Black school shoes<br>Dainfern College navy jersey with badge<br>Dainfern College peak cap   |
| WINTER | <b>GRADE 4-6 BOYS</b>   |
|        | White cotton blend tuck-in shirt with badge OR<br>Long-sleeved white winter shirt with badge<br>Charcoal trousers with belt (from school stockist only)<br>Charcoal socks and Black school shoes<br>Dainfern College navy jersey with badge<br>Dainfern College tracksuit top – <b>only to be worn in addition to the jersey – not instead of the jersey</b><br>Dainfern College peak cap   |
| WINTER | <b>GRADE 4-6 GIRLS</b>  |
|        | White cotton blouse with badge with side slits (not tucked in) OR<br>Long-sleeved white winter shirt with badge (tucked in)<br>Dainfern College tartan skirt OR culottes<br>Charcoal long pants with belt (from school stockist only)<br>Navy plain tights (from school stockist only) – worn with skirt OR<br>Charcoal socks – worn with trousers<br>Black school shoes<br>Dainfern College navy jersey with badge<br>Dainfern College tracksuit top – <b>only to be worn in addition to the jersey – not instead of the jersey</b><br>Dainfern College peak cap |

**Optional items:** Dainfern College navy sleeveless jersey with badge, Dainfern College padded jacket and Dainfern College scarf.

## Uniform requirements for Grade 7

|               |  |
|---------------|--|
| <b>SUMMER</b> | <b>GRADE 7 BOYS</b>  |
|               | Dainfern College white 'golf' shirt with badge (worn tucked in)<br>Charcoal trousers with belt (from school stockist only)<br>Charcoal socks & Black school shoes<br>Dainfern College navy blazer with badge<br>Dainfern College navy jersey<br>Dainfern College peak cap  |
|               | <b>GRADE 7 GIRLS</b>   |
|               | Dainfern College white 'golf' shirt with badge (worn tucked in)<br>Dainfern College tartan skirt OR culottes<br>Long white socks & Black school shoes<br>Dainfern College navy blazer with badge<br>Dainfern College navy jersey<br>Dainfern College peak cap  |
| <b>WINTER</b> | <b>GRADE 7 BOYS</b>  |
|               | Dainfern College white 'golf' shirt with badge OR<br>Long-sleeved white winter shirt with badge<br>Charcoal trousers with belt (from school stockist only)<br>Charcoal socks & Black school shoes<br>Dainfern College navy blazer with badge<br>Dainfern College peak cap  |
|               | <b>GRADE 7 GIRLS</b>   |
|               | Dainfern College white 'golf' shirt with badge OR<br>Long-sleeved white winter shirt with badge<br>Dainfern College tartan skirt OR culottes<br>Charcoal long pants with belt (from school stockist only)<br>Navy plain tights (from stockists only) – worn with skirt OR<br>Charcoal socks – worn with trousers<br>Black school shoes<br>Dainfern College navy blazer with badge<br>Dainfern College navy jersey<br>Dainfern College peak cap |

**Optional items:** Dainfern College navy sleeveless jersey with badge, Dainfern College padded jacket and Dainfern College scarf

## PE & Sports uniforms for Grades 4-7 boys & girls

For Physical Education (PE), students must wear their PE/sports shirt, school PE shorts, short **white** socks with tackies, and tracksuits. Students may wear PE kit to school on PE days except on Assembly day, when they are expected to come in full school uniform and change later for PE. The branded school tog bag is also required and is available from our stockists.

All students require a House T-shirt for all InterHouse activities in the following colours:

- Griffin – Yellow
- Kraken – Blue
- Phoenix – Red

House-coloured swimming caps (yellow, blue or red) are to be worn for swimming and InterHouse events; the white cap with the school logo is worn for interschool events.

Only the official sports kit may be worn when representing the school. Tracksuits are **compulsory** in Winter and have to be worn as a unit ie no tracksuit tops with formal uniforms, or tracksuit pants with jerseys/blazers. Tracksuits form part of all sports kit and **must** be worn to all matches or sporting events, unless otherwise indicated by the teacher in charge.

First teams have an official sports uniform in some of the sporting codes.

## PE uniform for Grades 4-7 boys & girls

|                           |  |
|---------------------------|--|
| <b>PHYSICAL EDUCATION</b> | <b>PHYSICAL EDUCATION - GRADES 4-7</b>   |
|                           | Dainfern College PE shirt<br>Dainfern College PE shorts or skort Dainfern College tracksuit (for winter) Short white socks & Sports tackies  |
|                           | <b>PHYSICAL EDUCATION: SWIMMING – GRADES 4-7</b>   |
|                           | Any navy-blue swimming costume suitable for school use (no bikinis) may be worn for PE<br><i>(The Dainfern College branded swimming costume is only compulsory for <b>members of the Swimming teams</b>)</i><br>Goggles (optional) |

Sports uniform for Grades 4-7 boys & girls

|   |   |
|---|---|
| <p><b>ATHLETICS &amp; CROSS COUNTRY</b></p> | <p>Dainfern College PE shirt<br/>                 Dainfern College PE shorts or <b>mid-quad navy</b> lycra shorts (girls)<br/>                 Dainfern College tracksuit for meetings<br/>                 White socks &amp; Sports tackies</p>  |
| <p><b>CRICKET: BOYS &amp; GIRLS</b></p>     | <p><b>Practices:</b><br/>                 Dainfern College PE shirt and shorts / skort<br/>                 Long blue or white socks</p> <p><b>Matches:</b><br/>                 Dainfern College 'golf' shirt (Girls' match shirts TBC)<br/>                 White shorts U9-U11; White long cricket pants for Opens<br/>                 Long white socks U9-U11; Short white socks for Opens</p> <p><b>All:</b><br/>                 Cricket boots <i>or</i> white sports shoes<br/>                 Wide brimmed white cricket hat/Dainfern College peak cap<br/>                 Blue Dainfern College cricket cap for <b>Open A team</b> only</p> |
| <p><b>GOLF</b></p>                          | <p><b>Practices:</b><br/>                 Dainfern College PE shirt<br/>                 Dainfern College navy tailored shorts (boys) / skort (girls)<br/>                 Long blue school socks or Short white socks</p> <p><b>Matches:</b><br/>                 Dainfern College red Golf shirt<br/>                 Stone/beige trousers<br/>                 Short white sports socks</p> <p><b>All:</b><br/>                 Golf shoes<br/>                 Dainfern College cap</p>   |
| <p><b>HOCKEY</b></p>                        | <p>Dainfern College PE shirt<br/>                 Dainfern College PE shorts (<b>Boys</b>) or skort (<b>Girls</b>)<br/>                 Dainfern College Long navy sports socks / Striped red and yellow sports socks – 1<sup>st</sup> Team only<br/>                 Sports tackies<br/>                 Shin pads (compulsory)<br/>                 Mouthguard (highly recommended)<br/>                 Hockey stick &amp; Ball</p>  |

|                 |   |
|-----------------|---|
| <b>NETBALL</b>  | Dainfern College PE shirt<br>Dainfern College sports skort<br>White short socks & Sports tackies  |
| <b>RUGBY</b>    | Dainfern College striped rugby jersey<br>Navy blue rugby shorts<br>Mouthguard (highly recommended)  |
| <b>SOCCER</b>   | Dainfern College PE shirt & Dainfern College PE shorts<br>Dainfern College Long navy sports socks / Striped red and yellow sports socks – 1st Team only<br>Soccer boots & Shin pads (compulsory)  |
| <b>SWIMMING</b> | <p><b>Practices:</b><br/>Any navy-blue swimming costume suitable for school use (no bikinis) may be worn for swimming practice<br/>Red/yellow/blue swimming cap<br/>Navy towel / Dainfern College towel / Swimming parka</p> <p><b>Galas:</b><br/>Dainfern College branded swimming costume<br/>White swimming cap with logo<br/>Dainfern College towel or Swimming parka<br/>Dainfern College tracksuit &amp;<br/>Dainfern College Tog bag</p> |
| <b>TENNIS</b>   | Dainfern College PE/sports shirt Dainfern College shorts / skort<br>White short socks & Sports tackies<br>Dainfern College Navy peak cap<br>Tennis racquet  |

We wish you and your family a very happy and successful association with Dainfern College.

## General information

|                            |  |             |
|----------------------------|--|-------------|
| <b>Telephone:</b>          | 010 020 5457 - Junior Preparatory<br>011 469 0635 - Main College switchboard |             |
| <b>Main school office:</b> | Hours  | 07h00-16h00 |
|                            | Holiday hours  | 08h00-13h00 |

---

|                              |  |
|------------------------------|--|
| <b>Senior Prep Principal</b> | <b>Mr Ray van Gass</b><br><a href="mailto:rvangass@dainferncollege.co.za">rvangass@dainferncollege.co.za</a>                         |
| Head of Grade 4              | <b>Mrs Lauren Nel</b><br><a href="mailto:lnel@dainferncollege.co.za">lnel@dainferncollege.co.za</a>                                  |
| Head of Grade 5              | <b>Mrs Sandy St Clair</b><br><a href="mailto:sstclair@dainferncollege.co.za">sstclair@dainferncollege.co.za</a>                      |
| Head of Grade 6              | <b>Mrs Ashleigh Lellyett-Kromm</b><br><a href="mailto:alellyettkromm@dainferncollege.co.za">alellyettkromm@dainferncollege.co.za</a> |
| Head of Grade 7              | <b>Mrs Karen Da Costa</b><br><a href="mailto:kdacosta@dainferncollege.co.za">kdacosta@dainferncollege.co.za</a>                      |

---

### College contacts:

|   |  |
|---|--|
| Executive Head &<br>High School Principal | <b>Mr Andrew Baker</b><br><a href="mailto:abaker@dainferncollege.co.za">abaker@dainferncollege.co.za</a>             |
| Junior Prep Principal                     | <b>Mrs Nicky Jansen van Vuuren</b><br><a href="mailto:nickyj@dainferncollege.co.za">nickyj@dainferncollege.co.za</a> |
| Communication &<br>Compliance Manager     | <b>Mrs Joanna Pettitt</b><br><a href="mailto:jpettitt@dainferncollege.co.za">jpettitt@dainferncollege.co.za</a>      |
| Enrolments Manager                        | <b>Mrs Fiona Siebert</b><br><a href="mailto:fsiebert@dainferncollege.co.za">fsiebert@dainferncollege.co.za</a>       |
| Fees Administrator                        | <b>Mrs Kerry Williams</b><br><a href="mailto:kwilliams@dainferncollege.co.za">kwilliams@dainferncollege.co.za</a>    |
| Head of Marketing                         | <b>Ms Lindokuhle Sithole</b><br><a href="mailto:lsithole@dainferncollege.co.za">lsithole@dainferncollege.co.za</a>   |

# School map

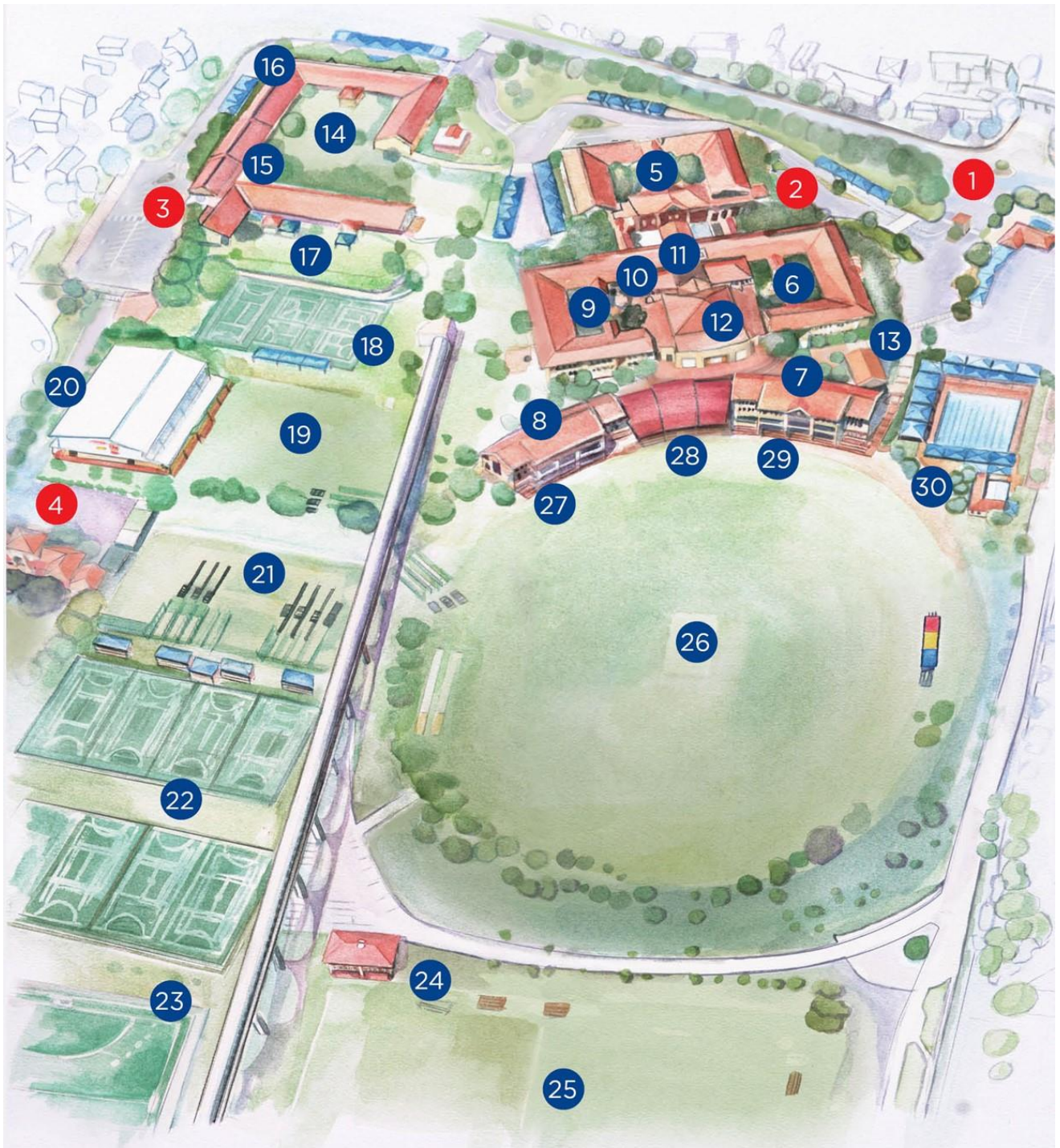

## KEY

- |   |   |   |
|---|---|---|
| 1. College entrance   | 10. The Garage makerspace               | 20. Multipurpose Hall                         |
| 2. Main reception   | 11. Ubambiswano makerspace & Town Hall  | 21. Cricket Academy                           |
| 3. Junior Prep reception  | 12. Auditorium                          | 22. Senior Prep & High School 'Plover' courts |
| 4. Country Readiness Pre-school   | 13. Tuckshop                            | 23. Hockey Astro                              |
| 5. High School amphitheatre quad  | 14. Junior Prep Grades 1-3              | 24. Sports Pavilion                           |
| 6. High School quad   | 15. Imaginarium makerspace              | 25. River Field                               |
| 7. Music Centre, High School Learning Support Centre and High School classrooms | 16. Junior Prep Learning Support Centre | 26. Main Oval                                 |
| 8. Senior Prep & High School classrooms   | 17. Grade 0 & Aftercare                 | 27. Staff & Function Room                     |
| 9. Senior Prep quad   | 18. Junior Prep 'Hadedá' courts         | 28. Main grandstand                           |
|   | 19. Junior Prep sports field            | 29. High Performance Centre                   |
|   |   | 30. Swimming pools                            |



# 2026 Term Calendar

| TERM 1 2026 (55 days) |                                      |                      |         |       |               |
|-----------------------|--------------------------------------|----------------------|---------|-------|---------------|
| START OF TERM 1       | WEDNESDAY 14 JANUARY                 |                      | Gr 1-12 | 07h30 |               |
|                       | THURSDAY 15 JANUARY                  |                      | Gr 0    | 08h00 |               |
| CLOSE OF TERM 1       | THURSDAY 2 APRIL                     |                      | Gr 0-7  | 11h30 | Gr 8-12 12h00 |
| Half term             | Close                                | Thursday 19 February | Gr 0-7  | 11h30 | Gr 8-12 12h00 |
|                       | Open                                 | Tuesday 24 February  | All     | 07h30 |               |
| Public holiday        | Saturday 21 March - Human Rights Day |                      |         |       |               |
| TERM 2 2026 (63 days) |                                      |                      |         |       |               |
| START OF TERM 2       | MONDAY 4 MAY                         |                      | All     | 07h30 |               |
| CLOSE OF TERM 2       | FRIDAY 7 AUGUST                      |                      | Gr 0-7  | 11h30 | Gr 8-12 12h00 |
| Half term             | Close                                | Friday 26 June       | Gr 0-7  | 11h30 | Gr 8-12 12h00 |
|                       | Open                                 | Monday 6 July        | All     | 07h30 |               |
| School holiday        | Monday 15 June                       |                      |         |       |               |
| Public holiday        | Tuesday 16 June - Youth Day          |                      |         |       |               |
| TERM 3 2026 (59 days) |                                      |                      |         |       |               |
| START OF TERM 3       | MONDAY 7 SEPTEMBER                   |                      | All     | 07h30 |               |
| CLOSE OF TERM 3       | WEDNESDAY 2 DECEMBER                 |                      | Gr 0-11 | TBC   |               |
| Half term             | Close                                | Thursday 22 October  | Gr 0-7  | 11h30 | Gr 8-12 12h00 |
|                       | Open                                 | Tuesday 27 October   | All     | 07h30 |               |
| Public holiday        | Thursday 24 September - Heritage Day |                      |         |       |               |
| School holiday        | Friday 25 September                  |                      |         |       |               |